

**TRIUMPH ACTIVATE FIRE RATED DIMMABLE LED MAINS
DOWNLIGHT 3000K WARM WHITE, 4000K COOL WHITE**

**RATR8P03038-01
RATR8P04038-01**

**PLEASE READ INSTRUCTION BEFORE COMMENCING INSTALLATION AND RETAIN FOR FUTURE REFERENCES.
! Electrical products can cause death or injury, or damage to property. If in any doubt about the installation or use of this product, consult a competent electrician**

Note:

Product technical information and specification may change over time without prior notification
For the latest technical information please visit our web site www.ledgrouprobus.com or robustdirect.com

Specifications

Product code:	RATR8P03038-01	RATR8P04038-01
Voltage:	220V-240V ~ 50Hz	220V-240V ~ 50Hz
Power:	8W	8W
Lumen	600lm	610lm
CCT:	3000K	4000K
CRI:	80	80
PF:	0.98	0.98
Beam Angle:	38°	38°
IP:	65	65
Ta range:	-20°C ~ 45°C	-20°C ~ 45°C
Safety Class:	Class I	Class I
Weight:	0.34Kg	0.34Kg
Installation:	Recessed Mounting	Recessed Mounting
Warranty:	5 Years	5 Years

Dimmable by Triac Rotary Dimmer
(See web site for dimmer compatibility list)
Suitable for mounting on normally flammable surface
Not suitable for use in ambient air temperature above 45°C
Complies with EN 60598-1, EN 60598-2-2, EN 55015,
EN 61000-3-2, EN 61000-3-3, EN 61547

Accessories

RATRTRIM-03	Polished Chrome Trim Accessory
RATRTRIM-13	Brushed Chrome Trim Accessory
RATRENS60	LEDCHROIC Lens 60 Degree Accessory

Dimensions:

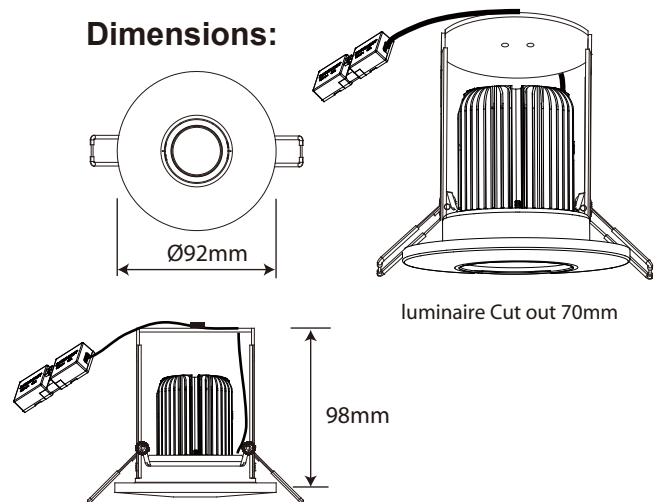

Safety Instructions:

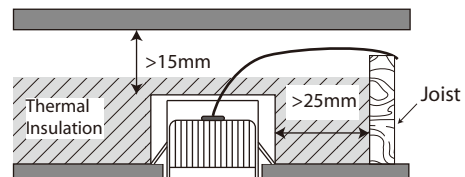

Minimum Clearance
>15mm above the fitting
>25mm all around the fitting

Information for the Product user:

1. Please note the requirement to dispose of Waste Electrical & Electronic Equipment separately from household waste (WEEE marked with crossed out wheelie bin symbol).
2. Please consider your role in contributing to re-use and recycling by returning this product at end of life to a collection centre for waste electrical equipment or a Civic Amenity site, or to a retail outlet from which you are purchasing a replacement.
3. This equipment may contain substances that are hazardous to health and the environment if disposed of carelessly. It is important that it is separated from normal household waste and recycled in the WEEE chain
4. The "crossed out wheelie bin symbol" on a product indicates this equipment must not be disposed of in normal household waste, but should be disposed of according to local WEEE regulations

The Installation must be carried out by a qualified electrician

Installation diagram:

1. Ensure mains supply is switched off before commencing work
2. It is possible to change twist and lock trims to a different colour (polished chrome or brushed chrome)
3. If required change to 60° lens (remove trim and release clips to change lens)
4. Before cutting, ensure that the hole does not impinge on joists, pipe work, cables or other building services
5. This luminaire requires a round hole $\text{Ø}70\text{mm}$ to be cut into the ceiling for correct installation. Connect AC power supply cable to the terminals of Swift connector. Brown/ Live to LS and Neutral/ Blue to N and Earth/ Green Yellow
6. The connector is supplied with 4 terminals. The 4th LP terminal can be used as common or as permanent live
7. Hold retention spring vertically against heat sink, push fitting through the cut-out until the springs come down on the upper side of the plasterboard. Ensure that the fitting is secure and the bezel is tight against the ceiling

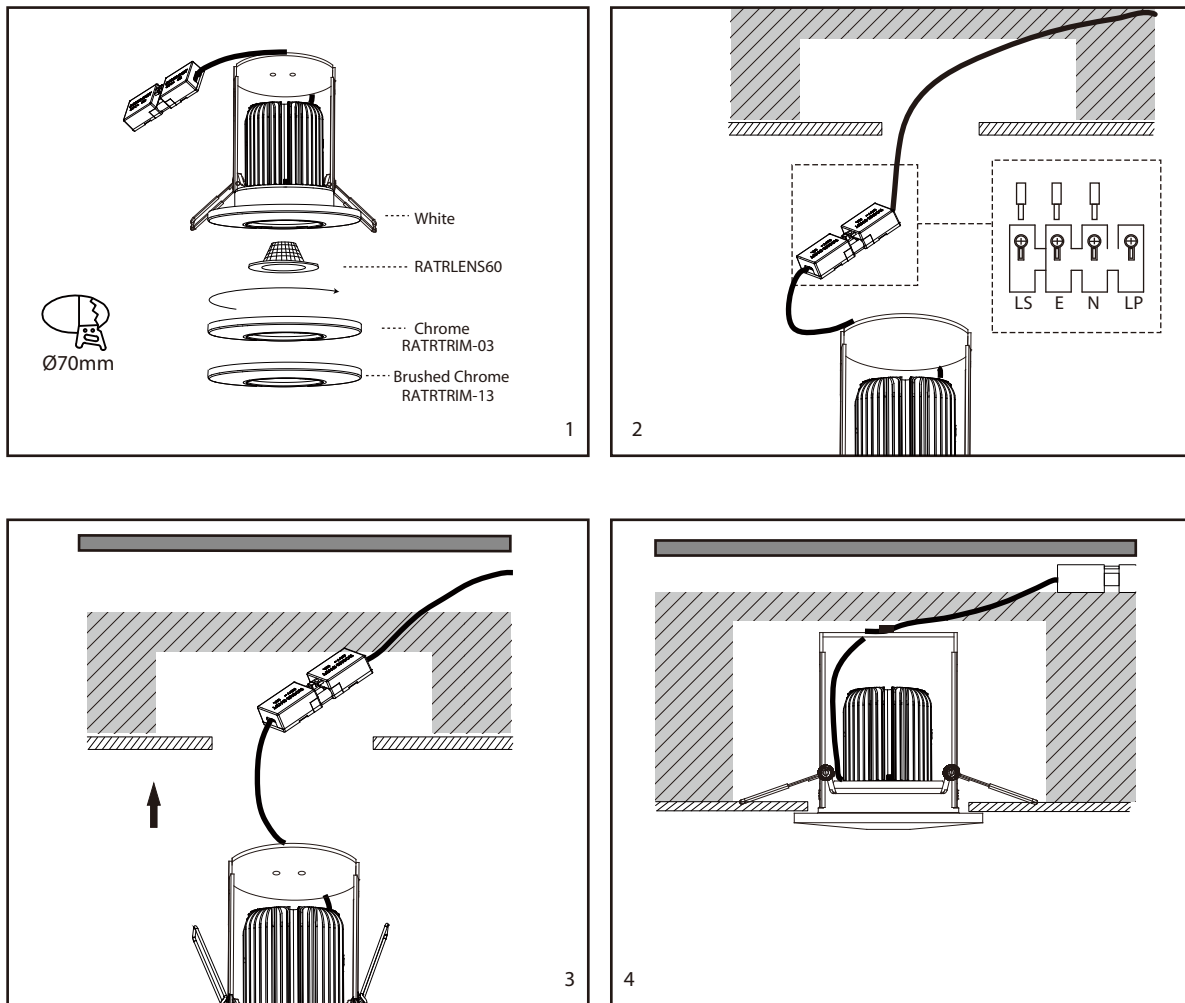

Information for the Product user:

1. Please note the requirement to dispose of Waste Electrical & Electronic Equipment separately from household waste (WEEE marked with crossed out wheelie bin symbol).
2. Please consider your role in contributing to re-use and recycling by returning this product at end of life to a collection centre for waste electrical equipment or a Civic Amenity site, or to a retail outlet from which you are purchasing a replacement.
3. This equipment may contain substances that are hazardous to health and the environment if disposed of carelessly. It is important that it is separated from normal household waste and recycled in the WEEE chain
4. The "crossed out wheelie bin symbol" on a product indicates this equipment must not be disposed of in normal household waste, but should be disposed of according to local WEEE regulations

The Installation must be carried out by a qualified electrician

LED Group
Western Retail Park
Nangor Road
Dublin 12
Ireland
Issue 1 190814

Tel: +353 1 7099000
Fax: +353 1 7099060
Email: info@led.ie
Website: www.led.ie

